

How to obtain a permit for use of the Off-Leash Recreation Areas

1. Your dog must be licensed by the city where you live before you can apply for an Off-Leash Recreation Area permit. For residents: A Minneapolis pet license application can be obtained online, at www.ci.minneapolis.mn.us . Minneapolis Animal Care and Control can be contacted at 612-348-4250.
2. Apply for an off-leash permit by filling out an Off-Leash Permit Application or applying online at www.minneapolisparcs.org .
3. The permits are valid for 12 months from the date of purchase.
4. The cost for Minneapolis residents is \$35 for the first dog and \$25 for each additional dog in the household. The fee for non-residents is \$60 for the first dog and \$35 for each additional dog in the household.
5. The off-leash permit is valid for all Minneapolis dog parks.

Rules for Off-Leash Recreation Areas

1. Off-Leash Recreation Areas are open during regular park hours from 6 a.m.-10 p.m.
2. All handlers must possess an off-leash permit for their dog(s).
3. Handlers must leash dogs except when they are inside an off-leash area.
4. Handlers must have their dog(s) under control at all times.
5. Handlers may not let their dog(s) out of sight.
6. Handlers must have one leash per dog.
7. All dogs must display off-leash tags.
8. An attending adult must closely supervise all children in off-leash areas.
9. Dogs declared dangerous animals under city code or dangerous or potential dangerous dogs under state statutes are not allowed in off-leash areas.
10. Handlers must leash dog(s) at the first sign of aggression or unruliness in off-leash areas.
11. Dogs in heat are not permitted in off-leash areas.
12. No more than three dogs per handler are permitted at one time in off-leash areas.
13. Handlers must always clean up after their dog(s) in off-leash areas.
14. Handlers must observe all other ordinances, rules and regulations.

How to report emergencies and criminal activity

1. Call 911 to report all emergencies and any criminal activity, including property damage. Police, fire and animal control will provide appropriate responses to these calls.
2. Failure to comply with reasonable request for compliance by any enforcement agent may result in police action, including the arrest of suspected violators of Park Board and City of Minneapolis regulations.
3. All reports about dog bites and attacks will be reviewed to determine whether the aggressive dog will be declared dangerous under state statute or city ordinance. If such a declaration is made, the off-leash permit will be immediately revoked.

Lake of the Isles
2845 .E. Lake of the Isles Parkway

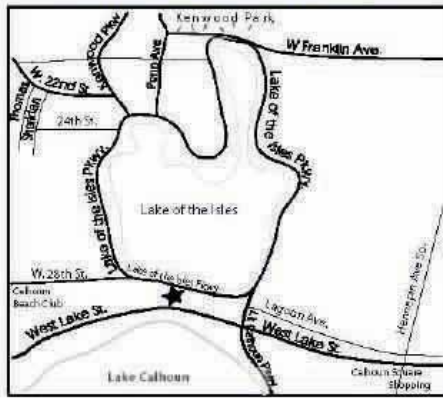

Dog park is adjacent to soccer field between Lake of the Isles Parkway and Lake St. on the south end of Lake of the Isles. (W. 28th St. becomes Lake of the Isles Parkway). One entrance to dog park on Lake of the Isles Parkway. Street parking only.

Franklin Terrace
925 Franklin Terrace

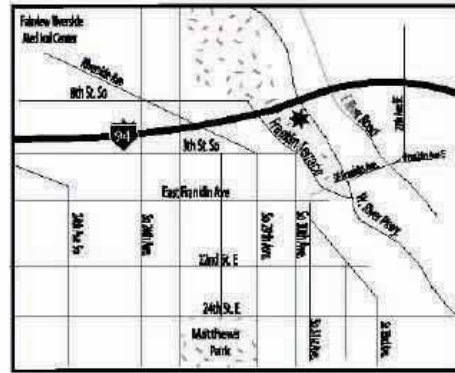

Dog park is portion of park east of I-94 (adjacent to Riverside Park). Entrances are on Franklin Terrace and W. River Parkway. Street parking only.

Minnehaha Park
5399 So. Minnehaha Park Drive

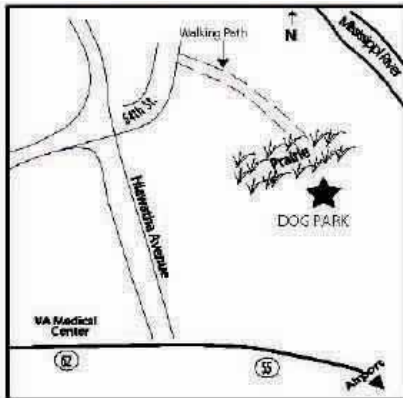

Dog park is on the south end of Minnehaha Park. Enter park at 54th St. & Hiawatha Avenue. Entrance to dog park is accessed by walking down a marked path. Parking lot at 54th Street.

St. Anthony Parkway
700 St. Anthony Parkway



Dog park is on the south side of St. Anthony Parkway, across the street from the Columbia Golf Learning Center. Access St. Anthony Parkway from University Avenue NE or Central Avenue. Park at the parking lot located west of the Columbia Golf Learning Center and near the kiosk.

Loring Park
1382 Willow Street



Dog Park located in the north corner of Loring Park between the Minneapolis Community Technical College and the Loring Park businesses. Street parking only.

Victory Prairie

4701 Russell Ave. N.

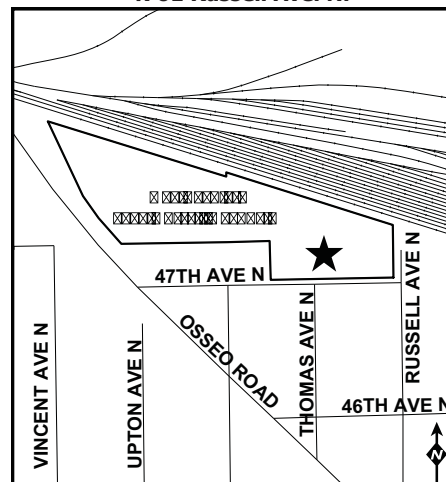

Located in the Camden neighborhood in an area commonly referred to as Victory Prairie. It is 2.7 acres at 47th Ave. N between Osseo Road and Russell Ave. Access is on the east side. Parking is along Russell, 47th and other residential streets.